

# Ferrite Cores

## For Power Supply

### PQ Cores

## PQ Series

### CORE SHAPES AND DIMENSIONS/CHARACTERISTICS

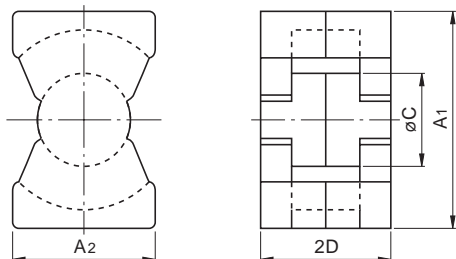

DE.PAT.2,944,583  
 DE.DES.15,655  
 EP.PAT.26,104(DE, FR, GB, NL)  
 GB.PAT.2,035,706  
 GB.DES.990,685  
 J.P.U.M 1,589,580  
 J.P.U.M 1,621,895  
 J.P.U.M PUB.  
 85(60)-3556 1,647,781  
 J.P.U.M PUB.  
 86(61)-5779 1,655,608  
 J.P.DES.580,081  
 J.P.DES.649,618  
 KR.U.M 23,487  
 NL.PAT.178,826  
 NL.DES.5,777  
 US.PAT.4,352,080  
 US.DES.264,959

Type	Dimensions (mm)		øC	2D	Ae (mm <sup>2</sup> )	le (mm)	Weight (g)
	A1	A2					
PQ20/16	20.5±0.4	14±0.4	8.8±0.2	16.2±0.2	62	37.4	13
PQ20/20	20.5±0.4	14±0.4	8.8±0.2	20.2±0.2	62	45.4	15
PQ26/20	26.5±0.45	19±0.45	12±0.2	20.15±0.25	119	46.3	31
PQ26/25	26.5±0.45	19±0.45	12±0.2	24.75±0.25	118	55.5	36
PQ32/20	32±0.5	22±0.5	13.45±0.25	20.55±0.25	170	55.5	42
PQ32/30	32±0.5	22±0.5	13.45±0.25	30.35±0.25	161	74.6	55
PQ35/35	35.1±0.6	26±0.5	14.35±0.25	34.75±0.25	196	87.9	73
PQ40/40	40.5±0.9	28±0.6	14.9±0.3	39.75±0.25	201	101.9	95
PQ50/50	50±0.7	32±0.6	20±0.35	49.95±0.25	328	113	195

### ELECTRICAL CHARACTERISTICS

#### WITHOUT AIR GAP

Part No.	AL-value (nH/N <sup>2</sup> ) [1kHz, 0.5mA, 100Ts]	Calculated output power* (W)
PC44PQ20/16Z-12	3880±25%	70[100kHz]
PC44PQ20/20Z-12	3150±25%	92[100kHz]
PC50PQ20/20Z-12	2000±25%	187[500kHz]
PC44PQ26/20Z-12	6170±25%	170[100kHz]
PC44PQ26/25Z-12	5250±25%	195[100kHz]
PC50PQ26/25Z-12	3200±25%	366[500kHz]
PC44PQ32/20Z-12	7310±25%	232[100kHz]
PC44PQ32/30Z-12	5140±25%	331[100kHz]
PC44PQ35/35Z-12	4860±25%	452[100kHz]
PC44PQ40/40Z-12	4300±25%	596[100kHz]
PC44PQ50/50Z-12	6720±25%	1045[100kHz]

\*The values were obtained with forward converter mode.

#### WITH AIR GAP

Part No.	AL-value (nH/N <sup>2</sup> ) [1kHz, 0.5mA, 100Ts]
PC44PQ20/16AXXX*-22	100±5%, 250±7%, 400±10%
PC44PQ20/20AXXX-22	100±5%, 250±7%, 400±10%
PC50PQ20/20AXXX-22	100±5%, 160±5%, 250±7%
PC44PQ26/20AXXX-22	160±5%, 315±5%, 630±10%
PC44PQ26/25AXXX-22	160±5%, 315±5%, 630±10%
PC50PQ26/25AXXX-22	100±5%, 250±5%, 400±7%
PC44PQ32/20AXXX-22	160±5%, 315±5%, 630±7%
PC44PQ32/30AXXX-22	160±5%, 315±5%, 630±7%
PC44PQ35/35AXXX-22	160±5%, 315±5%, 630±7%
PC44PQ40/40AXXX-22	160±5%, 315±5%, 630±7%
PC44PQ50/50AXXX-22	250±5%, 400±5%, 630±5%

\*XXX: AL-value

### BOBBINS

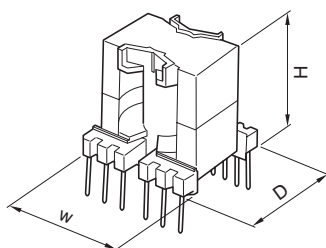

Part No.	No. of pin terminal	Dimensions (mm)			Clamp
		W	D	H	
BPQ20/16-1114CP	14	23	23	18.3	FPQ20/16-A
BPQ20/20-1114CP	14	23	23	22.3	FPQ20/20-A
BPQ26/20-1112CP	12	26.5	29.3	21.5	FPQ26/20-A
BPQ26/25-1112CP	12	26.5	29.3	29.1	FPQ26/25-A
BPQ32/20-1112CP	12	32	34	22.5	FPQ32/20-A
BPQ32/30-1112CP	12	32	34	32.1	FPQ32/30-A
BPQ35/35-1112CP	12	35	39	37.4	FPQ35/35-A
BPQ40/40-1112CP	12	40	42	42.3	FPQ40/40-A
BPQ50/50-1112DS	12	51	51	52	FPQ50/50-B

• Material: FR phenol, UL Grade: 94V-0, Pin material: Steel wire (Solder plated)