

EE 型磁心

EE Cores

ORDERING CODE SYSTEM

EE 13G DMR40

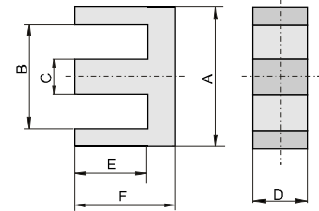
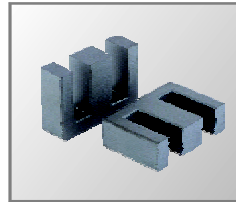
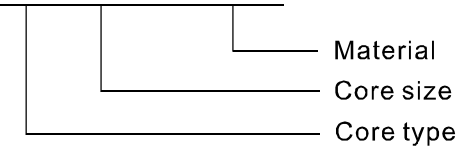

Dimension 型号 Part number 尺寸	A (mm)	B (mm)	C (mm)	D (mm)	E (mm)	F (mm)
EE13G	13.0±0.2	10.5±0.2	2.8 ^{+0.1} _{-0.2}	6.3 ⁺⁰ _{-0.3}	4.6±0.1	6.0±0.15
EE13H	13.3±0.2	10.0min	2.7±0.2	6.5±0.15	3.0±0.15	4.55±0.2
EE14	14.0±0.2	11.0±0.2	3.0±0.2	5.0±0.2	2.0±0.1	3.5±0.15
EE14A	14.0±0.2	11.0±0.2	2.9±0.2	6.0±0.2	3.9±0.1	5.4±0.15
EE16	16.1±0.3	11.8min	4.0±0.2	4.8±0.2	5.3±0.2	7.4±0.2
EE16A	16.1±0.3	11.3min	4.55±0.15	4.5±0.2	5.9±0.2	8.1±0.2
EE16B	16.0±0.3	11.8min	4.0±0.2	4.8±0.2	10.35±0.15	12.5±0.2
EE16B1	16.0±0.3	11.8min	4.0±0.2	4.8±0.2	10.2±0.2	12.3±0.2
EE16B2	16.0±0.3	12.1±0.3	4.0±0.2	4.8±0.2	10.4±0.2	12.4±0.2
EE16B3	16.0±0.3	11.8min	4.2 ⁰ _{-0.4}	5.1 ⁰ _{-0.4}	7.7±0.2	9.8±0.2
EE16B4	16.0±0.3	11.8min	4.0±0.2	3.7±0.2	10.2±0.2	12.25±0.2
EE16C	16.1±0.3	11.3min	4.55±0.15	7.2±0.2	3.75±0.15	6.0±0.2
EE16D	16.3±0.3	12.1min	4.0±0.2	4.8±0.2	10.2±0.2	12.4±0.2
EE16F	16.1±0.3	11.9min	3.8±0.2	4.75±0.2	4.4±0.125	6.4±0.1
EE16G	16.1±0.3	12.0±0.3	3.8±0.2	6.9±0.2	5.4±0.2	7.25±0.15
EE16G1	16.1±0.3	12.0±0.3	3.8±0.2	5.0 ⁰ _{-0.4}	5.2 ^{+0.25} ₀	7.1 ^{0.2} ₀
EE16H	16.0±0.3	12.0±0.3	4.15±0.15	9.9±0.3	2.4±0.15	4.4±0.1
EE16I	16.1±0.3	11.8min	4.0±0.2	4.8±0.2	5.2±0.15	7.3±0.2
EE16I1	16.1±0.3	11.8min	4.0±0.2	4.8±0.2	5.2 ^{+0.25} ₀	7.4±0.2
EE16J	16.0±0.3	11.8min	4.0±0.2	4.8±0.2	5.4±0.2	7.5±0.2
EE16L	16.1±0.4	12.8 ⁰ _{-0.3}	3.2 ^{+0.15} _{-0.2}	7.0 ⁰ _{-0.4}	5.4 ^{-0.2} ₀	7.0 ^{-0.3} ₀
EE17	17.2±0.3	12.8min	4.0±0.15	4.85±0.2	10.3±0.3	12.5±0.3
EE19	19.0±0.4	14.3min	4.6±0.2	4.8±0.2	5.7±0.2	8.2±0.2
EE19A	19.4±0.3	14.2min	4.85±0.25	4.85±0.25	11.4±0.3	13.6±0.3
EE19B	19.0±0.4	14.3min	4.6±0.2	5.0±0.2	5.7±0.2	8.2±0.2
EE19B1	19.0±0.3	14.3min	4.8 ⁰ _{-0.4}	5.0±0.2	5.85±0.2	8.35±0.2

打*号的可以生产DMR50材质的产品
 不打*号的可以用同一付模具生产功率铁氧体部分的其它不同材质的产品
 These parts with the*have the DMR50 tooling.
 These parts without the*have all the power ferrite toolings except DMR50.

EE 型磁心

EE Cores

ORDERING CODE SYSTEM

EE 13G DMR40

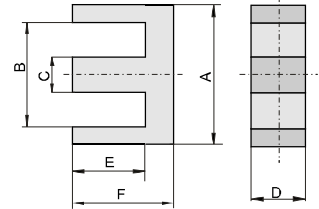
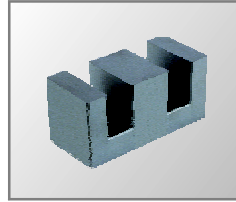
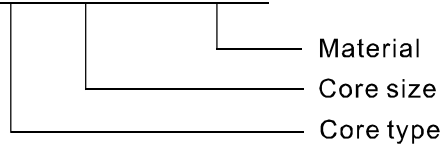

型号 Part number	Parameter 参数	C_1 (mm^{-1})	L_e (mm)	A_e (mm^2)	重量 (g) Weight	AL ($\pm 25\%nH$) DMR40
EE13G		1.85	30.3	16.4	2.5	
EE13H		1.32	24.1	18.2	2.3	
EE14		1.38	20.7	15.0	1.7	1100
EE14A		1.59	28.4	17.8	2.0	
EE16		1.83	37.1	19	3.5	1200
EE16A		1.87	37.6	20.1	4.0	1050
EE16B		2.92	55.8	19.1	5.4	750
EE16B1		2.92	55.8	19.1	5.4	700
EE16B2		2.92	55.8	19.1	5.4	700
EE16B3		3.05	45.3	14.8	3.7	
EE16B4		2.83	55.2	19.5	5.4	
EE16C		0.90	29.1	32.5	4.9	2000
EE16D		2.85	55.6	19.6	5.4	900
EE16F		1.72	32.1	18.7	3.0	1200
EE16G		1.34	35.8	26.6	4.7	1550
EE16G1		1.91	34.5	18.6	3.3	
EE16H		0.59	23.8	40.0	4.9	2800
EE16I		1.83	35.7	19.5	3.5	1200
EE16I1		1.83	35.7	19.5	3.5	1200
EE16J		1.85	36.1	19.5	3.6	1200
EE16L		1.65	36.6	22.2	4.1	1450
EE17		2.85	56.9	20.0	5.6	800
EE19		1.80	40.2	22.3	4.6	1300
EE19A		2.71	55.5	18.0	8.0	820
EE19B		1.65	40.2	24.3	4.8	1200
EE19B1		1.75	40.8	23.2	4.8	

打*号的可以生产DMR50材质的产品
 不打*号的可以用同一付模具生产功率铁氧体部分的其它不同材质的产品
 These parts with the*have the DMR50 tooling.
 These parts without the*have all the power ferrite toolings except DMR50.

EE 型磁心

EE Cores

ORDERING CODE SYSTEM

EE 19C DMR40

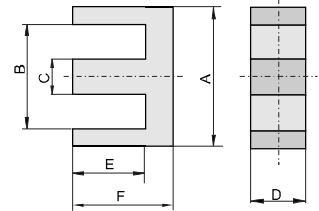
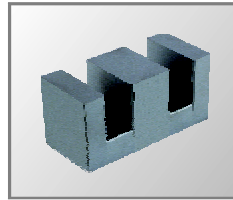
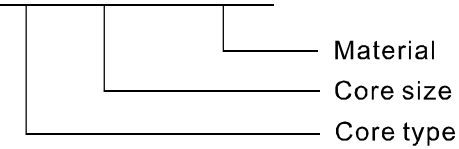

Dimension 型号 Part number	A (mm)	B (mm)	C (mm)	D (mm)	E (mm)	F (mm)
EE19C	19.15±0.5	14.45min	4.65±0.2	9.58±0.25	5.6±0.25	7.9±0.25
EE19D	19.0±0.4	14.3min	4.6±0.2	4.8±0.2	5.8±0.2	8.3±0.2
EE19E	19.0±0.3	14.3min	4.7 ⁰ _{-0.5}	5.0±0.2	5.65±0.2	8.05±0.2
EE19E1	19.0±0.3	14.3min	4.7 ⁰ _{-0.5}	5.0±0.2	5.8±0.2	8.2±0.2
EE19E2	19.0±0.3	14.3min	4.7 ⁰ _{-0.5}	4.9±0.2	5.6±0.2	7.95±0.2
EE19E3	19.0±0.3	14.2min	4.7 ⁰ _{-0.5}	5.2 ⁰ _{-0.4}	5.5±0.15	7.9±0.2
EE19E4	19.0±0.3	14.3min	4.7 ⁰ _{-0.5}	4.85±0.15	5.7±0.2	8.0±0.3
EE19F	19.0±0.3	14.0 ^{+0.3} _{-0.1}	5.0 ^{+0.1} _{-0.2}	7.85 ⁰ _{-0.4}	5.0 ^{+0.2} ₀	7.55±0.2
EE19G	19.0±0.3	14.2min	4.85±0.25	4.85±0.25	11.3±0.3	13.6±0.3
EE19J	19.0±0.3	14.5±0.3	4.6±0.2	5.2 ⁰ _{-0.4}	5.8±0.15	8.2±0.2
EE20	20.0±0.4	14.1min	5.7±0.2	5.7±0.2	7.2±0.2	10.0±0.2
EE20A	20.0±0.4	11.9min	5.7±0.3	5.65±0.3	7.2±0.25	9.9±0.25
EE20B	20.4 ⁰ _{-0.8}	14.1 ^{+0.6} ₀	5.9 ⁰ _{-0.3}	5.9 ⁰ _{-0.4}	8.4±0.2	11.2±0.2
EE20C	20.5±0.4	14.7min	5.0±0.2	7.0±0.3	7.0±0.2	10.4±0.2
EE20D	20.3±0.4	15.3min	4.8±0.2	4.8±0.2	6.2±0.2	8.4±0.2
EE20E	20.0±0.4	14.1min	5.7±0.2	5.65±0.25	6.3±0.2	9.1±0.2
EE20F	20.5±0.4	15.5min	4.8±0.15	6.85±0.15	6.45±0.2	9.0±0.2
EE20J	20 ^{+0.4} _{-0.3}	14.3min	4.55±0.2	5.0 ^{+0.07} _{-0.2}	22.3±0.3	27.4±0.5
EE20H	20.0±0.3	14.5min	4.7±0.3	4.8±0.2	11.3±0.2	13.6±0.2
EE20H1	20.0±0.3	14.2min	4.6±0.2	4.8±0.2	11.3±0.2	13.6±0.3
EE20H2	20.0±0.3	14.2min	4.6±0.2	4.8±0.2	11.3min	13.6 ^{+0.6} _{-0.1}
EE20H3	20.0±0.3	14.3min	4.6 ^{+0.1} _{-0.2}	4.8±0.2	11.3±0.2	13.6±0.3
EE20H4	20.0±0.3	14.2min	4.6±0.2	4.8±0.2	11.4±0.2	13.8±0.3
EE22	22.0±0.4	12.8min	5.75±0.25	5.75±0.25	5.4±0.2	9.4±0.2
EE22A	22.0±0.4	16.0±0.4	5.75±0.25	5.75±0.25	5.6±0.2	9.7±0.2
EE22B	22.25±0.3	15.5min	5.7±0.3	5.7±0.3	11.2±0.3	15.26±0.3
EE22C	22.0±0.4	15.6min	5.75±0.25	5.75±0.25	11.0±0.2	15.0±0.2
EE22D	22.0±0.3	16.0min	5.75±0.25	5.75±0.25	10.8±0.2	14.65±0.25

打*号的可以生产DMR50材质的产品
 不打*号的可以用同一付模具生产功率铁氧体部分的其它不同材质的产品
 These parts with the*have the DMR50 tooling.
 These parts without the*have all the power ferrite toolings except DMR50.

EE 型磁心

EE Cores

ORDERING CODE SYSTEM

EE 19C DMR40

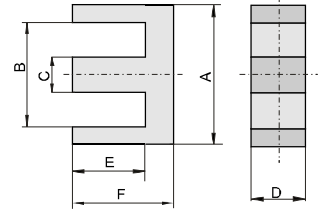
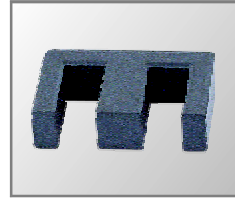
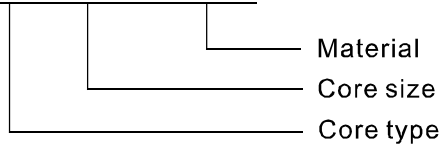

型号 Part number	Parameter 参数	C_1 (mm^{-1})	L_e (mm)	A_e (mm^2)	重量 (g) Weight	AL ($\pm 25\%nH$) DMR40
EE19C		0.86	39.5	45.8	8.7	2400
EE19D		1.83	40.6	22.1	4.6	1200
EE19E		1.70	39.7	23.4	4.8	1250
EE19E1		1.65	39.7	24.1	4.8	1250
EE19E2		1.79	39.7	22.1		
EE19E3		1.72	39.3	22.9	4.2	
EE19E4		1.82	40.0	21.9	4.4	
EE19F		0.99	37.3	37.6	7.0	2200
EE19G		2.75	62.1	22.5	7.0	
EE19J		1.75	40.4	23.1		
EE20		1.45	46.0	32.0	7.3	1400
EE20A		1.34	44.9	33.5	8.2	2100
EE20B		1.58	51.1	32.2	8.3	
EE20C		1.20	46.9	39.1	9.7	
EE20D		1.94	42.8	22.0	4.8	1400
EE20E		1.34	42.7	31.8	6.9	1600
EE20F		1.34	44.5	33.3	7.5	1400
EE20J		4.05	106.0	26.2	15.0	
EE20H		2.69	62.6	23.3	7.3	900
EE20H1		2.65	62.2	23.4	7.4	900
EE20H2		2.71	63.3	23.3	7.5	
EE20H3		2.67	62.2	23.3	7.4	
EE20H4		2.65	62.8	23.7	7.5	
EE22		0.98	39.8	40.8	9.2	2300
EE22A		1.15	42.9	37.2	8.5	2150
EE22B		1.79	65.1	36.4	12.2	1600
EE22C		1.80	64.3	35.8	12.2	1400
EE22D		1.82	63.5	34.9		

打*号的可以生产DMR50材质的产品

不打*号的可以用同一付模具生产功率铁氧体部分的其它不同材质的产品

These parts with the*have the DMR50 tooling.

These parts without the*have all the power ferrite toolings except DMR50.