

Main applications :

High frequency electronic balasts,

Resonant circuits, induction heaters

High-end audio applications



**GENERAL TECHNICAL CHARACTERISTICS**

- Dielectric : Polypropylene film
- Construction : Extended metallized film
- Case : Polyester tape wrapping; UL94V-0 resin end fill
- Leads: Tinned copper wire

**ELECTRICAL CHARACTERISTICS**

- Working temperature : - 40 to + 85 °C
- Capacitance : 0.1 to 60.0µF
- Rated Voltage : 250 to 700 Vdc
- Tolerance : ± 5%, ± 10%
- Dissipation factor: Measured at 1000±20 Hz and 25±5°C.  
When Cr≤5.0µF,  $6 \times 10^{-4}$ ;  
When Cr>5.0µF,  $10 \times 10^{-4} - 15 \times 10^{-4}$

**TEST METHODS AND PERFORMANCES**

- Dielectric strength: 2Ur (DC) applied for 10s at 25±5°C (1 minute for type test)
- Insulation resistance : 3000s but need not exceed 30GΩ (typical value), after 1 minute of electrification at 100Vdc (25±5°C)

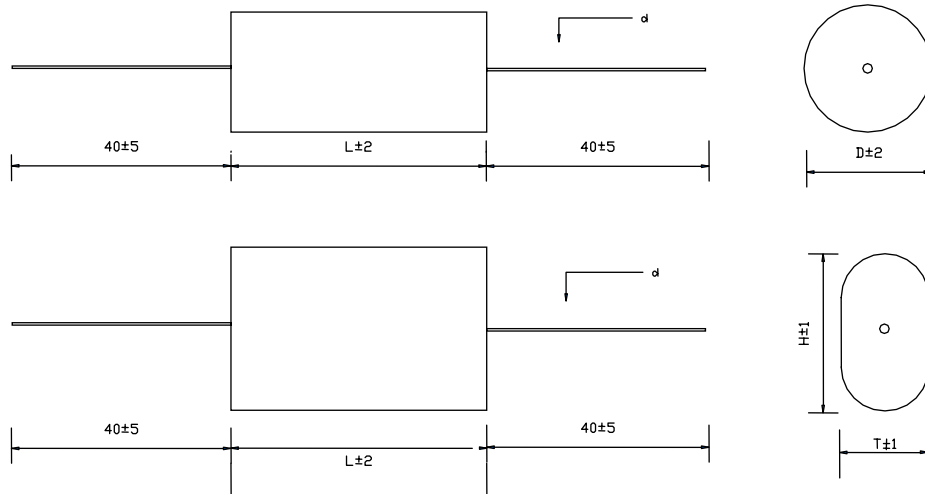

**Electrical specifications, ordering codes**

Part Nubmer	Cap (µF)	Dimension (mm)					Du/dt (v/µs)	Ipeak (A)	Irms max. (A)	ESR (mΩ)
		flat, oval								
		L	D	T	H	d				
<b>Ur 250Vdc, Upk 400Vdc, Urms 160Vac</b>										
STH-250-1.0	1.0	27	9.0	6.5	11.3	0.8	50	50	4.5	7.2
STH-250-1.5	1.5	27	10.6	8.1	12.9	0.8	50	75	5	5.8
STH-250-2.0	2.0	27	12.1	8.3	16.3	0.8	50	100	5.5	4.9
STH-250-2.0	2.0	32	10.4	7.9	12.7	0.8	40	80	5	5.7
STH-250-2.2	2.2	32	10.9	8.4	13.2	0.8	40	88	6.5	4.8
STH-250-2.2	2.2	32	12.6	8.8	16.8	0.8	40	88	6	5.4
STH-250-2.5	2.5	27	13.4	9.5	17.5	0.8	50	125	7	4.5
STH-250-2.5	2.5	32	11.5	9.0	13.8	0.8	40	100	7	5.1
STH-250-3.0	3.0	27	14.5	10.6	18.6	0.8	50	150	7	4.2

## Electrical specifications, ordering codes

Part Number	Cap ( $\mu$ F)	Dimension (mm)					Du/dt (V/ $\mu$ s)	Ipeak A	Irms max. (A)	ESR (m $\Omega$ )
		flat, oval								
		L	D	T	H	d				
STH-250-3.0	3.0	32	12.5	8.6	16.6	0.8	40	120	7	4.6
STH-250-3.3	3.3	32	13.0	9.1	17.1	0.8	40	132	7	4.2
STH-250-4.0	4.0	32	14.2	10.3	18.3	1.0	40	160	9	3.6
STH-250-4.7	4.7	32	15.3	11.3	19.3	1.0	40	188	9	3.3
STH-250-5.0	5.0	32	15.7	11.8	19.8	1.0	40	200	9	3.2
STH-250-6.8	6.8	32	18.2	14.1	22.1	1.0	40	272	9	2.9
STH-250-10	10	32	22.0	16.3	27.5	1.0	40	400	9	2.4
STH-250-10	10	37	19.9	15.6	23.6	1.0	30	300	9	3.1
STH-250-15	15	37	24.1	18.3	29.5	1.2	30	450	12	2.6
STH-250-20	20	37	27.7	21.8	33.0	1.2	30	600	12	5.0
STH-250-22	22	37	29.0	23.0	34.2	1.2	30	660	12	4.7
STH-250-25	25	57	30.8	24.8	36.0	1.2	15	375	12	4.4
STH-250-30	30	47	28.8	22.8	34.0	1.2	25	750	12	4.5
STH-250-33	33	47	30.1	24.2	35.4	1.2	25	825	12	4.3
STH-250-33	33	57	26.8	20.9	32.1	1.2	15	495	12	5.0
STH-250-40	40	47	33.0	27.0	38.2	1.2	25	1000	12	3.9
STH-250-40	40	57	29.3	23.4	34.6	1.2	15	600	12	4.5
STH-250-50	50	47	37.9	31.8	43.0	1.2	25	1250	12	3.5
STH-250-50	50	57	33.4	27.4	38.6	1.2	15	750	12	3.9
STH-250-60	60	57	36.5	30.5	41.7	1.2	15	900	12	3.5
<b>Ur 330Vdc, Upk 500Vdc, Urms 200Vac</b>										
STH-330-0.68	0.68	27	9.6	7.1	11.9	0.8	60	41	4.5	8.7
STH-330-1.0	1.0	27	11.3	8.8	13.6	0.8	60	60	5.5	6.6
STH-330-1.5	1.5	27	13.6	9.7	17.7	0.8	60	90	6.5	5.3
STH-330-1.5	1.5	32	11.7	9.2	14.0	0.8	45	68	6	6.0
STH-330-2.0	2.0	27	15.5	11.5	19.5	0.8	60	120	7	4.5
STH-330-2.0	2.0	32	13.3	9.4	17.4	0.8	45	90	7	5.4
STH-330-2.2	2.2	27	16.2	12.2	20.2	0.8	60	132	7	4.1
STH-330-2.2	2.2	32	13.9	10.0	18.0	0.8	45	99	8	5.1
STH-330-3.0	3.0	32	16.0	12.0	20.0	1.0	45	135	9	4.2
STH-330-3.3	3.3	32	16.8	12.7	20.7	1.0	45	149	9	4.1
STH-330-4.0	4.0	32	18.3	14.3	22.3	1.0	45	180	9	3.6
STH-330-4.7	4.7	32	19.8	15.7	23.7	1.0	45	212	9	3.1
STH-330-4.7	4.7	37	17.9	13.9	21.9	1.0	35	165	9	4.0
STH-330-5.0	5.0	32	20.4	14.9	26.1	1.0	45	225	9	3.0
STH-330-5.0	5.0	37	18.4	14.4	22.4	1.0	35	175	9	3.9
STH-330-6.8	6.8	32	23.6	18.0	29.2	1.0	45	306	9	3.4
STH-330-6.8	6.8	37	21.3	15.8	27.0	1.0	35	238	9	5.7
STH-330-10	10	37	26.2	20.4	31.6	1.0	35	350	10	6.7
STH-330-15	15	37	32.5	26.6	37.8	1.2	35	525	12	5.4
STH-330-15	15	47	27.1	21.3	32.5	1.2	28	420	12	6.8
STH-330-20	20	37	36.7	30.7	41.9	1.2	35	700	12	5.1
STH-330-20	20	47	31.1	25.3	36.5	1.2	28	560	12	5.8
STH-330-22	22	47	32.6	26.7	37.9	1.2	28	616	12	4.8
STH-330-22	22	57	29.3	23.4	34.6	1.2	20	440	12	5.4
STH-330-25	25	47	35.3	29.3	40.5	1.2	28	700	12	4.5
STH-330-25	25	57	31.1	25.2	36.4	1.2	20	500	12	5.0
STH-330-30	30	47	38.6	32.5	43.7	1.2	28	840	12	4.1
STH-330-30	30	57	34.0	28.0	39.2	1.2	20	600	12	4.5
STH-330-33	33	47	40.4	34.3	45.5	1.2	28	924	12	3.9
STH-330-33	33	57	35.6	29.6	40.8	1.2	20	660	12	4.3
STH-330-35	35	57	35.9	29.9	41.1	1.2	20	700	12	3.8
STH-330-35	35	57	40.4	34.4	45.6	1.2	20	700	12	4.2
STH-330-40	40	57	38.3	32.2	43.4	1.2	20	800	12	3.9

### Electrical specifications, ordering codes

Part Number	Cap (µF)	Dimension (mm)					Du/dt (V/µs)	Ipeak (A)	Irms max. (A)	ESR (mΩ)
		flat, oval								
		L	D	T	H	d				
<b>Ur 400Vdc, Upk 600Vdc, Urms 250Vac</b>										
STH-400-0.68	0.68	27	11.6	9.1	13.9	0.8	75	51	5.5	6.7
STH-400-0.68	0.68	32	11.6	9.1	13.9	0.8	55	37	5.5	8.5
STH-400-1.0	1.0	32	11.7	9.2	14.0	0.8	55	55	6	5.5
STH-400-1.0	1.0	32	11.7	9.2	14.0	0.8	55	55	6	6.4
STH-400-1.5	1.5	32	14.1	10.2	18.2	0.8	55	83	77	4.5
STH-400-1.5	1.5	32	14.1	10.2	18.2	0.8	55	83	9	5.3
STH-400-2.0	2.0	32	16.1	12.1	20.1	1.0	55	110	9	4.4
STH-400-2.2	2.2	32	16.8	12.8	20.8	1.0	55	121	9	4.2
STH-400-2.5	2.5	32	17.9	13.8	21.8	1.0	55	138	9	4.0
STH-400-3.0	3.0	32	19.5	15.4	23.4	1.0	55	165	9	3.6
STH-400-3.3	3.3	32	20.6	14.9	26.1	1.0	55	182	9	3.5
STH-400-3.3	3.3	37	18.5	14.3	22.3	1.0	45	149	9	4.1
STH-400-4.0	4.0	32	22.5	16.7	27.9	1.0	55	220	9	3.1
STH-400-4.0	4.0	37	20.3	14.6	25.8	1.0	45	180	9	3.7
STH-400-4.7	4.7	37	21.9	16.1	27.3	1.0	45	212	9	7.7
STH-400-5.0	5.0	37	22.5	16.7	27.9	1.0	45	225	9	7.5
STH-400-6.8	6.8	37	26.0	20.2	31.4	1.2	45	306	11	6.4
STH-400-10	10	47	26.7	20.8	32.0	1.2	36	360	12	5.4
STH-400-10	10	57	23.7	17.9	29.1	1.2	25	250	12	6.3
STH-400-15	15	47	32.4	26.4	37.6	1.2	36	540	12	5.0
STH-400-15	15	57	28.7	22.8	34.0	1.2	25	375	12	5.6
STH-400-20	20	47	37.3	31.2	42.4	1.2	36	720	12	4.3
STH-400-20	20	57	33.0	27.0	38.2	1.2	25	500	12	4.7
STH-400-22	22	47	39.1	33.0	44.2	1.2	36	792	12	4.1
STH-400-22	22	57	34.6	28.5	39.7	1.2	25	550	12	4.5
STH-400-25	25	47	41.6	35.5	46.7	1.2	36	900	12	3.8
STH-400-25	25	57	36.8	30.7	41.9	1.2	25	625	12	4.2
<b>Ur 600Vdc, Upk 800Vdc, Urms 330Vac</b>										
STH-600-0.33	0.33	27	10.8	8.3	13.1	0.8	95	31	4	9.0
STH-600-0.47	0.47	27	12.7	8.8	16.8	0.8	95	45	5	7.9
STH-600-0.47	0.47	32	9.7	7.2	12.0	0.8	75	35	5	8.9
STH-600-0.68	0.68	27	15.0	11.1	19.1	0.8	95	65	6	6.5
STH-600-0.68	0.68	32	11.3	8.8	13.6	0.8	75	51	6	7.4
STH-600-1.0	1.0	32	13.5	9.6	17.6	1.0	75	75	8	5.8
STH-600-1.5	1.5	32	16.2	12.2	20.2	1.0	75	113	9	4.7
STH-600-2.0	2.0	32	18.6	14.5	22.5	1.0	75	150	9	3.9
STH-600-2.0	2.0	37	16.7	12.7	20.7	1.0	60	120	9	5.0
STH-600-2.2	2.2	32	19.5	15.4	23.4	1.0	75	165	9	3.6
STH-600-2.2	2.2	37	17.5	13.5	21.5	1.0	60	132	9	4.6
STH-600-2.5	2.5	37	18.6	14.5	22.5	1.0	60	150	9	4.4
STH-600-3.0	3.0	37	20.3	14.8	26.0	1.0	60	180	9	4.0
STH-600-3.3	3.3	37	21.4	15.7	26.9	1.0	60	198	9	3.8
STH-600-4.0	4.0	37	23.4	17.6	28.8	1.2	60	240	12	3.4
STH-600-4.7	4.7	37	25.3	19.5	30.7	1.2	60	282	12	6.4
STH-600-4.7	4.7	47	21.6	15.8	27.0	1.2	50	235	12	7.7
STH-600-4.7	4.7	57	19.2	14.9	22.9	1.2	40	188	11	8.6
STH-600-5.0	5.0	37	29.6	23.7	34.9	1.2	60	300	12	6.3
STH-600-5.0	5.0	47	22.2	16.4	27.6	1.2	50	250	12	7.4
STH-600-5.0	5.0	57	19.7	15.5	23.5	1.2	40	200	11	8.3
STH-600-6.8	6.8	47	25.7	19.8	31.0	1.2	50	340	12	6.5
STH-600-6.8	6.8	57	22.8	17.0	28.2	1.2	40	272	12	7.3
STH-600-10	10	47	30.9	25.0	36.2	1.2	50	500	12	5.4
STH-600-10	10	57	27.4	21.5	32.7	1.2	40	400	12	6.1
STH-600-12.5	12.5	47	34.5	28.4	39.6	1.2	50	625	12	4.9
STH-600-12.5	12.5	57	30.5	24.6	35.8	1.2	40	500	12	5.5
STH-600-15.0	15	57	33.3	27.3	38.5	1.2	40	600	12	5.1

**Electrical specifications, ordering codes**

Part Number	Cap (µF)	Dimension (mm)					Du/dt (v/µs)	Ipeak A	Irms max. (A)	ESR (mΩ)
		flat, oval								
		L	D	T	H	d				
<b>Ur 700Vdc, Upk 1000Vdc, Urms 400Vac</b>										
STH-700-0.22	0.22	27	11.0	8.5	13.3	0.8	135	30	3.5	10.2
STH-700-0.22	0.22	32	9.5	7.0	11.8	0.8	105	23	3.5	11.0
STH-700-0.33	0.33	27	13.2	9.3	17.3	0.8	135	45	4.5	8.1
STH-700-0.33	0.33	32	11.3	8.8	13.6	0.8	105	35	4.5	8.9
STH-700-0.47	0.47	27	15.6	11.6	19.6	0.8	135	63	6.5	6.6
STH-700-0.47	0.47	32	13.2	9.3	17.3	0.8	105	49	6.5	7.3
STH-700-0.68	0.68	32	15.7	11.7	19.7	1.0	105	71	8	5.7
STH-700-1.0	1.0	32	18.8	14.7	22.7	1.0	105	105	9	4.3
STH-700-1.0	1.0	37	16.9	12.9	20.9	1.0	75	75	9	6.3
STH-700-1.2	1.2	32	20.5	15.0	26.2	1.0	105	126	9	3.7
STH-700-1.2	1.2	37	18.4	14.4	22.4	1.0	75	90	9	6.0
STH-700-1.5	1.5	37	20.5	15.0	26.2	1.0	75	113	9	5.3
STH-700-2.0	2.0	37	23.5	17.9	29.1	1.2	75	150	12	4.6
STH-700-2.2	2.2	37	24.6	18.9	30.1	1.2	75	165	12	4.3
STH-700-2.5	2.5	37	26.3	20.4	31.6	1.2	75	188	12	4.0
STH-700-3.0	3.0	37	28.7	22.8	34.0	1.2	75	225	12	6.1
STH-700-3.3	3.3	37	30.1	24.1	35.3	1.2	75	248	12	5.9
STH-700-4.7	4.7	47	30.3	24.4	35.6	1.2	65	306	12	6.1
STH-700-4.7	4.7	57	26.9	21.0	32.2	1.2	45	212	12	7.0
STH-700-5.0	5.0	47	31.2	25.3	36.5	1.2	65	325	12	5.8
STH-700-5.0	5.0	57	27.7	21.8	33.0	1.2	45	225	12	5.6
STH-700-6.8	6.8	47	36.3	30.2	41.4	1.2	65	442	12	5.1
STH-700-6.8	6.8	57	32.1	26.1	37.3	1.2	45	306	12	5.8
STH-700-8.2	8.2	47	39.7	33.6	44.8	1.2	65	533	12	4.6
STH-700-8.2	8.2	57	35.1	29.1	40.3	1.2	45	369	12	5.3
STH-700-10.0	10	57	38.7	32.6	43.8	1.2	45	450	12	4.9
<b>Ur 850Vdc, Upk 1200Vdc, Urms 450Vac</b>										
STH-850-0.15	0.15	32		6.4	12.8	0.8	300	45	4.5	10.8
STH-850-0.22	0.22	32		8.0	14.4	0.8	300	66	5.0	7.8
STH-850-0.33	0.33	32	14.3	10.2	16.6	0.8	300	99	6.5	6.0
STH-850-0.47	0.47	32	16.6	12.5	18.9	1.0	300	141	9	5.4
STH-850-0.47	0.47	37	15.1	11.0	17.4	1.0	250	118	8	5.5
STH-850-0.68	0.68	32	19.5	15.4	21.8	1.0	300	204	9	4.3
STH-850-0.68	0.68	37	17.7	13.5	19.9	1.0	250	170	9	5.4
STH-850-1.0	1.00	32	23.2	19.1	25.5	1.0	300	300	9	3.2
STH-850-1.0	1.00	37	21.0	16.9	23.3	1.0	250	250	9	4.3
STH-850-1.5	1.50	37	25.3			1.0	250	375	9	3.5
STH-850-2.0	2.00	37	28.9			1.2	250	500	12	2.9
STH-850-2.5	2.50	37	32.1			1.2	250	625	12	3.6
STH-850-2.5	2.50	47	27.4			1.0	180	450	12	4.1
STH-850-3.0	3.00	47	29.8			1.0	180	330	12	3.4
STH-850-3.3	3.30	57	27.7			1.2	110	363	12	4.3
STH-850-4.0	4.00	57	30.4			1.2	110	440	12	3.2
STH-850-4.7	4.70	57	32.8			1.2	110	517	12	2.8
STH-850-5.0	5.00	57	33.7			1.2	110	550	12	2.7
STH-850-6.8	6.80	57	39.1			1.2	110	748	12	2.3

**How to Order:**

STH-600 - 0.47 - 47 FO

