

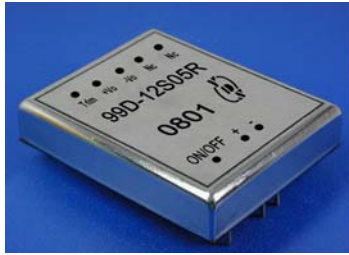

## Wide Input Voltage Range 40 Watt Dc-Dc Converter



### FEATURES:

- 2:1 Wide Input Voltage.
- Efficiency To 80%
- 700Vdc Isolation
- Regulated Output Types
- MTBF:>1,500,000 hrs
- Operating Temperature:-40°C TO +85°C



### Specifications typical at TA=25°C, nominal input voltage and rated output current unless otherwise specified

Part Number	Input Voltage	Output Voltage	Output Current	Efficiency
	Vdc	Vdc	mA	%TYP
99D-12S05R	9-18	5	6000	80
99D-12S12R	9-18	12	2500	84
99D-24S05R	18-36	5	8000	80
99D-24S12R	18-36	12	4000	84
99D-24S15R	18-36	15	3000	84
99D-24S24R	18-36	24	2000	84
99D-48S05R	36-72	5	8000	80
99D-48S12R	36-72	12	4000	84
99D-48S15R	36-72	15	3000	84
99D-48S24R	36-72	24	2000	84

### Input Specifications

Parameters	Conditions	Min	Typ	Max	Units
Voltage Types				2:1	
Filter	Capacitor				

### Output Specifications

Parameters	Conditions	Min	Typ	Max	Units
Voltage Tolerance				±2	%
Short Circuit Protection	Continuous				
Line Regulation				±0.1	%
Load Regulation	Single(FL-NL)			±1.0	%
Ripple & Noise	BW=DC To 20MHz			100	mVp-p
Transient response setting time	50% load step change		350		us

### General Specifications

Parameters	Conditions	Min	Typ	Max	Units
Isolation Resistance	500Vdc	1000			MΩ
Switichingfrequency			300		KHz
Operating Temperature		-40		85	°C
Humidity	Non Condensing			95	%
Cooling	Free air Convection				
Case material	Black Coated Copper With Non-Conductive Base				
Weight			110		g
Dimensions			76.20x63.50x8.65		mm



Wide Input Voltage Range 40 Watt Dc-Dc Converter

Temperature Derating Graph

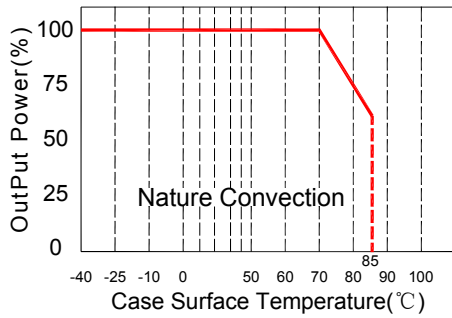

Tolerance Envelope Graph

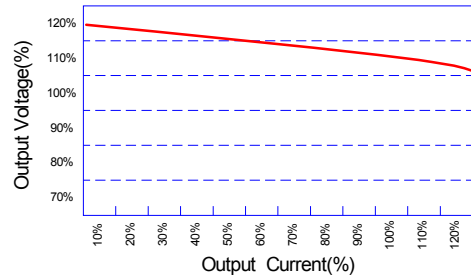

Recommended Test Circuit

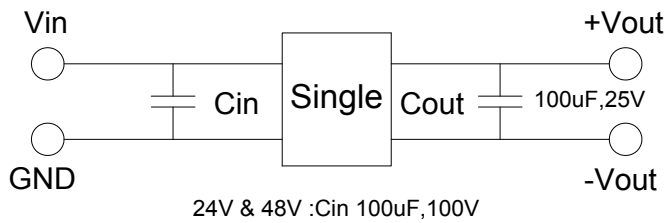

Part Number

99D - 24 S 05 R NL  
 A B C D E F  
 A:Series  
 B:Input Voltage  
 C:Single(S)  
 D:Output Voltage  
 E:Regulated(R)  
 F:RoHS Version

Markings and dimensions

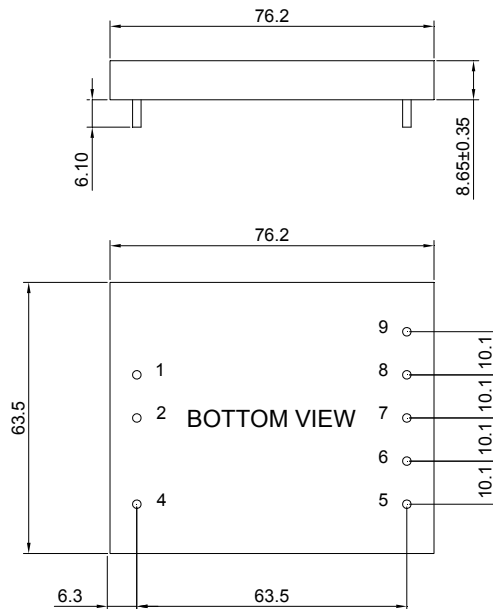

Unit: mm Unless otherwise specified, all tolerances are ±0.25

PIN Connection

PIN	1	2	3	4	5	6	7	8
SINGLE	+Vin	-Vin	NO PIN	Ctrl	NO PIN	+Vout	-Vout	Trim