

Ferrite Cores

For Power Supply

ETD, EC Cores

ETD, EC Series

ETD, EC SERIES

CORE SHAPES AND DIMENSIONS/CHARACTERISTICS

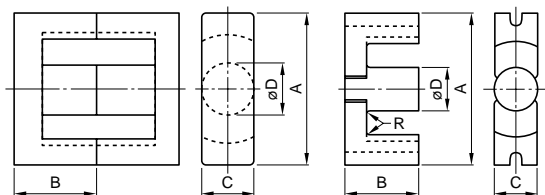
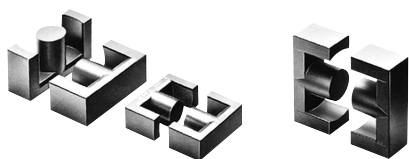

Fig.1

Fig.2



Type	Fig.	Dimensions (mm)				Ae (mm ²)	le (mm)	Weight (g)
		A	B	C	øD			
ETD19	1	19.6±0.5	13.65±0.15	7.4±0.2	7.4±0.2	41.3	54.6	14
ETD24	1	24.4±0.6	14.45±0.15	8.5±0.4	8.5±0.2	56.3	61.9	20
ETD29	1	29.8±0.8	15.8±0.15	9.5±0.3	9.5±0.3	73.6	70.6	28
ETD34	1	34.2±0.8	17.3±0.2	10.88±0.38	10.8±0.3	97.1	78.6	40
ETD39	1	39.1±0.9	19.8±0.2	12.58±0.38	12.5±0.3	125	92.1	60
ETD44	1	44±1	22.3±0.2	14.9±0.5	14.8±0.4	175	103	94
ETD49	1	48.7±1.1	24.7±0.2	16.4±0.5	16.3±0.4	213	114	124
EC70	2	70±1.7	34.5±0.15	16.4±0.4	16.4±0.4	279	144	256
EC90	2	90±1.8	45±1.3	30±1	30±1	624	216	698
EC120	2	120±2	50.5±1	30±1	30±1	753	250	780

ELECTRICAL CHARACTERISTICS WITHOUT AIR GAP

Part No.	AL-value (nH/N ²) [1kHz, 0.5mA, 100Ts]	Calculated output power* (W) [100kHz]
PC40ETD19-Z	1720±25%	79
PC40ETD24-Z	2125±25%	115
PC40ETD29-Z	2500±25%	170
PC40ETD34-Z	2780±25%	271
PC40ETD39-Z	3150±25%	382
PC40ETD44-Z	4000±25%	523
PC40ETD49-Z	4440±25%	682
PC40EC70-Z	4800±25%	
PC40EC90-Z	6000min.	
PC40EC120-Z	6300min.	

* The values were obtained with forward converter mode.

WITH AIR GAP

Part No.	AL-value (nH/N ²) [1kHz, 0.5mA, 100Ts]
PC40ETD19AXXX*	80±5%, 160±7%
PC40ETD24AXXX	100±5%, 200±7%
PC40ETD29AXXX	200±5%, 400±10%
PC40ETD34AXXX	200±5%, 400±7%
PC40ETD39AXXX	200±5%, 400±7%
PC40ETD44AXXX	250±5%, 400±7%
PC40ETD49AXXX	250±5%, 400±7%
PC40EC70AXXX	100±5%, 200±5%

* XXX: AL-value

BOBBINS

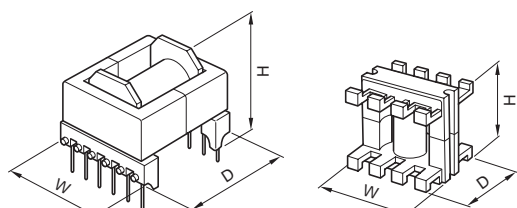

Fig.1

Fig.2

Part No.	Fig.	No. of pin terminal	Dimensions (mm)			Materials
			W	D	H	
BETD-19-1110CPH*	1	10	23.55	31	18.15	FR phenol
BETD-24-1112CPH*	1	12	29	33.6	21.65	FR phenol
BEC-70-5116	2		72	57	70	6-Nylon
BEC-90-0112	2		92	77	93	6-Nylon

* Permissible soldering temperature 350°C max., 2 seconds.

• UL Grade: 94V-0, Pin material: Steel wire (Solder plated)