

EER Cores

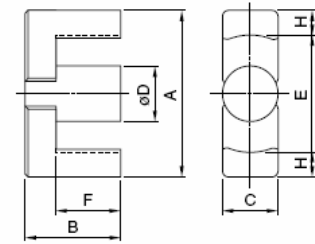

Type 1

Part No.	U.S. lam. cores, DIN standard JIS	Type	Dimensions in mm inches						
			A	B	C	D	E	F	H
							min.		
PC40EER25.5-Z	JIS FEER25.5A	1	25.5±0.5 1.004±.020	9.3±0.2 .366±.008	7.5±0.2 .295±.008	7.5±0.15 .295±.006	19.8 .779	6.2±0.2 .244±.008	2.6 .102
PC40EER28-Z	JIS FEER28.5A	2	28.55±0.55 1.124±.022	14.0±0.2 .551±.008	11.4±0.25 .499±.010	9.9±0.25 .390±.010	21.2 .835	9.65±0.25 .380±.010	3.4 .134
PC40EER28L-Z	JIS FEER28.5B	2	28.55±0.55 1.124±.022	16.9±0.25 .665±.010	11.4±0.25 .499±.010	9.9±0.25 .390±.010	21.2 .835	12.53±0.28 .493±.011	3.4 .134
PC40EER35-Z	JIS FEER35A	1	35.0±0.5 1.378±.020	20.7±0.2 .815±.008	11.3±0.2 .445±.008	11.3±0.15 .445±.006	25.6 1.009	14.7±0.3 .579±.012	4.43 .174
PC40EER40-Z		1	40.0±0.5 1.575±.020	22.4±0.2 .882±.008	13.3±0.25 .524±.010	13.3±0.25 .524±.010	29.0 1.142	15.4±0.3 .606±.012	5.28 .208
PC40EER42-Z	JIS FEER42	1	42.0±0.6 1.654±.024	22.4±0.2 .882±.008	15.5±0.25 .610±.010	15.5±0.25 .610±.010	29.4 1.157	15.4±0.3 .606±.012	6.0 .236
PC40EER42/42/20-Z		2	42.15±0.65 1.659±.026	21.2±0.2 .835±.008	19.60±0.4 .772±.016	17.3±0.25 .681±.010	31.8 1.252	15.25±0.25 .600±.010	4.93 .194
PC40EER49-Z		1	49.0±0.8 1.929±.031	19.0±0.3 .748±.012	17.2±0.4 .677±.016	17.2±0.25 .677±.010	36.4 1.433	12.4±0.2 .488±.008	6.0 .236

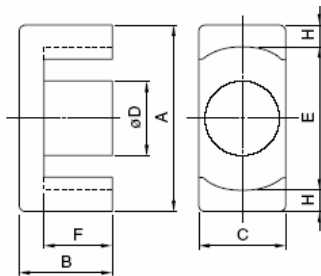

Type 2

Effective parameter			Electrical characteristics			Wt (g)	Bobbin item	
C ₁ (mm ⁻¹)	A _e (mm ²)	l _e (mm)	V _e (mm ³)	AL-value (nH/N ²)*	Core loss (W) max.			
				Without air gap	With air gap	100kHz, 200mT, 100°C		
1.08	44.8	48.2	2160	1920±25%	100±5% 200±7%	0.98	11	BEER25.5-118CPFR
0.780	82.1	64.0	5250	2870±25%	200±5% 400±7%	2.30	28	BEER28-1110CPFR BEER28-1112CPHFR
0.928	81.4	75.5	6150	2520±25%	160±5% 315±7%	2.70	33	BEER28L-1110CPFR BEER28L-1112CPHFR
0.849	107	90.8	9720	2770±25%	200±5% 400±7%	4.20	52	BEER35-1112CPFR BEER35-1116CPHFR
0.658	149	98.0	14600	3620±25%	200±5% 400±7%	6.30	78	BEER40-1112CPFR BEER40-1116CPHFR
0.509	194	98.8	19200	4690±25%	250±5% 500±7%	8.60	102	BEER42-1114CPFR BEER42-1116CPHFR
0.411	240	98.6	23700	5340±25%	250±5% 500±7%	10.7	116	BEER42/20-1112CPFR
0.395	231	91.3	21100	6250±25%	250±5% 500±7%	5.4**	110	BEER49-1118CPFR

* AL-value: 1kHz, 0.5mA, 100Ts

** Core loss: 100kHz, 150mT, 100°C