

Title		
Size	Number	Revision
A4		
Date:	2011-3-26	Sheet of
File:	Sheet1.SchDoc	Drawn By:

Bill of Materials

<Parameter Title not found>

Source Data From: EB2011-1.PrjPCB
 Project: EB2011-1.PrjPCB
 Variant: None

Creation Date: 2011-3-26 下午01:37:47
 Print Date: 40628 40628.56798

Footprint	Comment	LibRef	Designator	Description	Quantity
KBU807	Bridge1	Bridge1	B1	Full Wave Diode Bridge	1
CAP0.71	2uF/680V	Cap Semi	C1	Capacitor (Semiconductor SIM Model)	1
RB.1/.126	47uF/50V	Cap Pol1	C3	Polarized Capacitor (Radial)	1
R0805	1nF	Cap Semi	C4, C24, C32, C33, C34, C35, C36, C37, C38, C39, C43	Capacitor (Semiconductor SIM Model)	11
R0805	10nF	Cap Semi	C5, C23	Capacitor (Semiconductor SIM Model)	2
150u/400V	680uF/250V	Cap Pol1	C6, C7	Polarized Capacitor (Radial)	2
Y2	0.1uF/250V	Cap Semi	C8	Capacitor (Semiconductor SIM Model)	1
Y2	33nF/250V	Cap Semi	C9	Capacitor (Semiconductor SIM Model)	1
R0805	4.7nF	Cap Semi	C10, C11, C28, C31	Capacitor (Semiconductor SIM Model)	4
C9	10nF/100V	Cap Semi	C12	Capacitor (Semiconductor SIM Model)	1
CAP0.19	68pF/1KV	Cap Semi	C13, C14	Capacitor (Semiconductor SIM Model)	2
CAP0.3	220pF/1KV	Cap Semi	C15, C16, C17	Capacitor (Semiconductor SIM Model)	3
CAP0.3	470pF/1KV	Cap Semi	C18, C19, C20	Capacitor (Semiconductor SIM Model)	3
CAP0.593	1.2nF/1KW	Cap Semi	C21	Capacitor (Semiconductor SIM Model)	1
CAP0.19	100pF/1KV	Cap Semi	C22	Capacitor (Semiconductor SIM Model)	1
R0805	1uF	Cap Semi	C25, C26	Capacitor (Semiconductor SIM Model)	2
RB.1/.126	22uF/25V	Cap Pol1	C27	Polarized Capacitor (Radial)	1
R0805	150nF	Cap Semi	C29, C30	Capacitor (Semiconductor SIM Model)	2
CAP0.3	2.2nF/1KV	Cap Semi	C40, C41, C44, CY1, CY2	Capacitor (Semiconductor SIM Model)	5
R0805	0.68uF	Cap Semi	C42	Capacitor (Semiconductor SIM Model)	1
CT1	CT1	Header 2	CT1	Header, 2-Pin	1
CT1	CT2	Header 2	CT2	Header, 2-Pin	1
X2	0.22uF	Cap Semi	CX1	Capacitor (Semiconductor SIM Model)	1
X2	0.1uF	Cap Semi	CX2	Capacitor (Semiconductor SIM Model)	1
DIODE0.135	1N4148	Diode	D1, D3, D4, D10, D11, D14	Default Diode	6
U860	U860	Diode	D2	Default Diode	1
DIODE0.135	36V	D Schottky	D5	Schottky Diode	1
DIODE0.135	15V	D Schottky	D6, D7, D8, D9, D13	Schottky Diode	5
DIODE0.135	10V	D Schottky	D12	Schottky Diode	1
Fuse base	Fuse 1	Fuse 1	FUSE	Fuse	1
LB7	80uH	Inductor	L1	Inductor	1
LB7	1.33uH	Inductor	L2	Inductor	1
L-MMS	12.83uH	Inductor	L3	Inductor	1
LB9	800uH	Trans Coupl	LF1	Transformer (Coupled Inductor Model)	1
LB9	33mH	Trans Coupl	LF2	Transformer (Coupled Inductor Model)	1
LA-power	0.488uH	Inductor Adj	LT1, LT2	Adjustable Inductor	2
SO-8-14	MC33262D	MC33262D	MC33262	Power Factor Controller	1
NTC	NTC	Res2	NTC	Resistor	1
FQPF	MOSFET-N	MOSFET-N	Q1, Q4, Q5	N-Channel MOSFET	3
TO-92-5	KSP 2907A	2N3906	Q2	PNP General Purpose Amplifier	1
TO-92-5	KSP 2222A	2N3904	Q3	NPN General Purpose Amplifier	1
TO-92-5	S8050	2N3904	Q6	NPN General Purpose Amplifier	1
TO-92-5	S8550	2N3906	Q7	PNP General Purpose Amplifier	1
1206-14	1.3M	Res2	R1	Resistor	1
1206-14	12K	Res2	R2	Resistor	1
AXIAL0.197	100K/1W	Res2	R3	Resistor	1
1206-14	100	Res2	R4	Resistor	1
1206-14	22K	Res2	R5	Resistor	1
1206-14	47	Res2	R6	Resistor	1
AXIAL0.197	0.1/1W	Res2	R7	Resistor	1
1206-14	1.5M	Res2	R8	Resistor	1
1206-14	10K	Res2	R9, R19, R20, R21	Resistor	4
1206-14	500K	Res2	R10	Resistor	1
1206-14	470K	Res2	R11, R12, R13, R14, R15, R16, R17, R18, R26, R27, R28, R29	Resistor	12
1206-14	330	Res2	R22, R23, R24, R25, R37	Resistor	5
1206-14	33K	Res2	R30, R31	Resistor	2
1206-14	4.7K	Res2	R32, R33, R34	Resistor	3
1206-14	700K	Res2	R35	Resistor	1
1206-14	4.7	Res2	R36	Resistor	1
RP1	Res Adj2	Res Adj2	RP1	Variable Resistor	1
R1st	RV	Res2	RV1, RV2, RV3	Resistor	3
PFC	PFC	Trans Coupl	T1	Transformer (Coupled Inductor Model)	1
PFC	190uH	Trans Coupl	T1/T6257A	Transformer (Coupled Inductor Model)	1
LB6	1:1:1	Trans3	T2	Three-winding Transformer (Non-Ideal)	1
					125

Approved	Notes

MECHANICAL SPECIFICATIONS

PHYSICAL PARAMETERS (INCHES)		
DIMENSIONS	MIN	MAX
A: WIDTH		2.10
B: LENGTH		1.90
C: HEIGHT		1.75
D: LEAD LENGTH	.120	.180

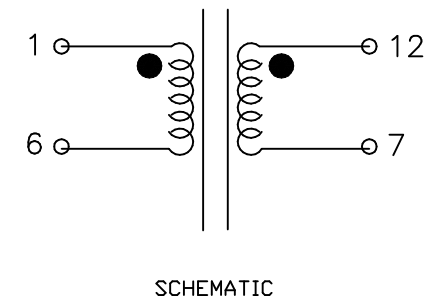
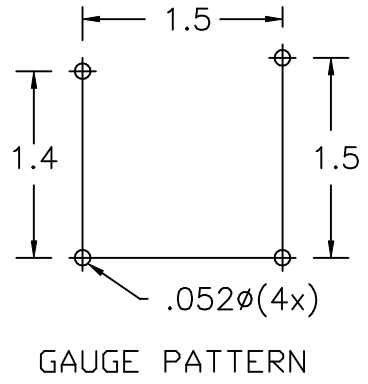
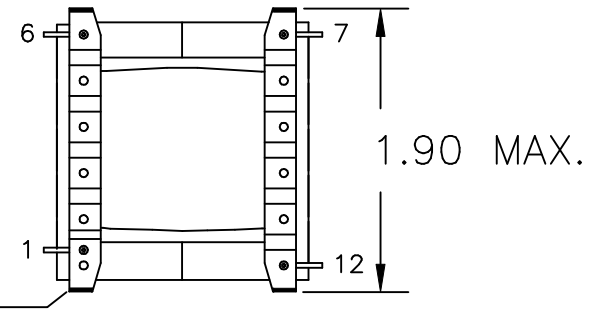
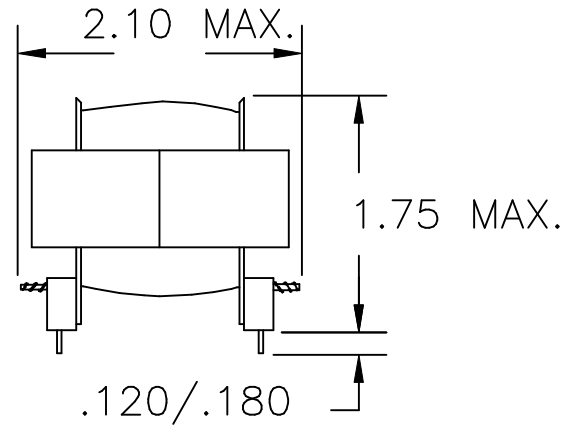

ELECTRICAL SPECIFICATIONS

INDUCTANCE(uh) 100%		
15.75 KHZ, 1.0 VRMS, 0 ADC		
PINS	MIN	MAX
1-6	171	209

HI POT 100%		
(VRMS, to be applied for 1 minute)		
VOLTAGE:	FROM PINS	TO PINS
500	1	7
500	1,7	core

VOLTAGE RATIO 100%		
Apply 1.0 Vrms, 20 KHZ to pins 12-6		
MEASURE PINS:	MIN	MAX
7, 1-6	.899	.955
WITH 7-1 CONNECTED		

DC RESISTANCE (OHMS) A/R		
PINS	MIN	MAX
1-6		.068
12-7		.015

Customer	
COILCRAFT	
P/N	Rev.
T6257-A	
Sample#	
T6257-A	
EW0	Date
Engineer	
Drawing Name	
T6257-A.DWG	

STAMP
T6257-A
CCIXXXX

WARNING! THIS DRAWING AND ALL INFORMATION CONTAINED WITHIN IS PROPRIETARY TO COILCRAFT & SHALL NOT BE DIVULGED WITHOUT PRIOR ENGINEERING CONSENT